

DDG-697 Project

Plaza
Drive

DDG Riggins 150 UPS

Riggins Avenue

DDG-402V

Merck

Goshen

Visalia/
Sequoia
National Park
KOA Journey

DDG-244V
(Building A)

Diversified
DDevelopment
Group

7519 N. Ingram #104, Fresno, CA 93711

Google

DDG - 697

RIGGIN AVENUE (AVE 312)

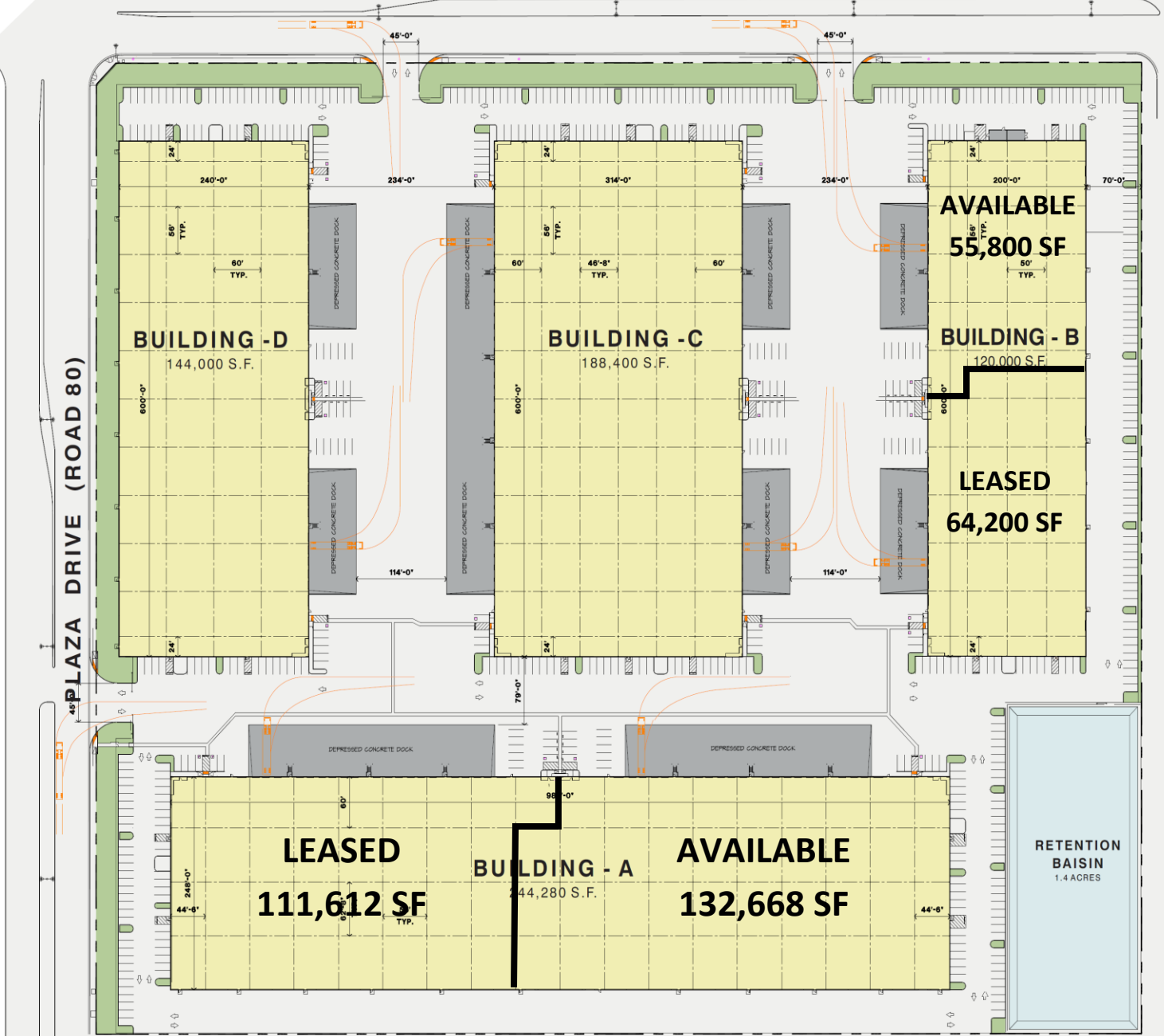

J B B DEVELOPMENT

7519 N. INGRAM , SUITE 104
FRESNO, CA. 93704
PH 559.225.6363

1 SITE PLAN

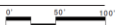

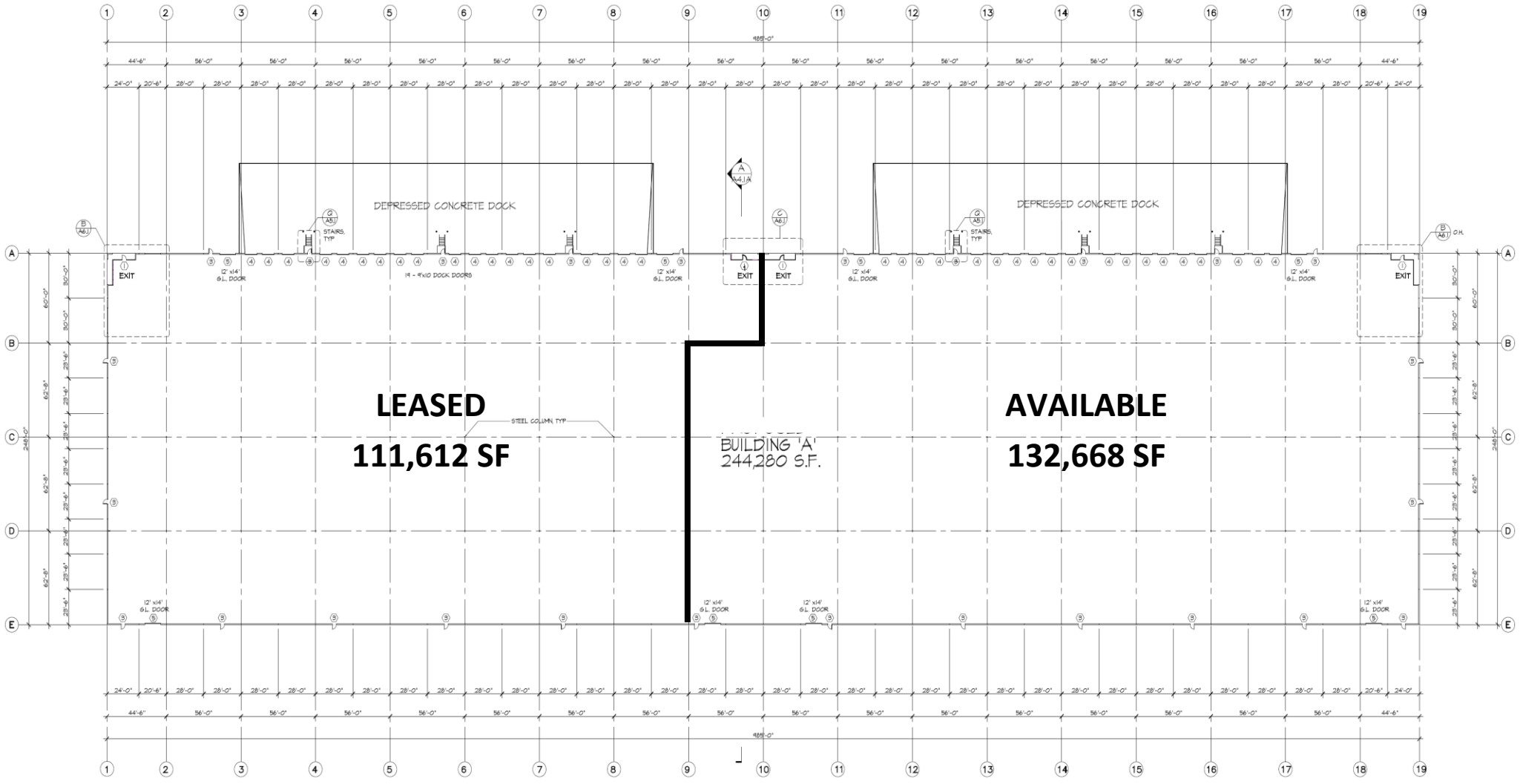

FLOOR PLAN BUILDING - A
 SCALE: 1" = 30'

DDG 244V

SPECIFICATIONS

BUILDING SIZE:	244,280 SF
SPACE AVAILABLE:	132,668 SF
SPACE DIMENSIONS:	248' x 436.5' and 492.5'
COLUMN SPACING:	56' x 50'
CONCRETE WALLS:	8"
CONCRETE SLAB:	6", laser screed
CLEAR HEIGHT:	30' minimum clear height
ROOF CONSTRUCTION:	Panelized System
ROOFING:	.60 TPO
SKY LIGHTS:	4' x 8' - 4 per bay
CROSS DOCK:	145' truck court
DOCK CONSTRUCTION:	60' dock apron, reinforced 6" concrete, ±1% slope
TRUCK DOORS:	<u>North Elevation</u> . Nineteen (19) 9' x 10' dock high doors and two (2) 12' x 14' grade level doors. <u>South Elevation</u> . Three (3) 12' x 14' grade level doors.
FIRE SYSTEM:	K-17 ESFR System with 150 HP booster pump.
LOCATION:	Southeast corner Plaza Drive and Riggin Visalia, CA 93291

*For further information, please contact
Marcus Pignotti*

(559) 225-6363, ext. 8